

2021/22 KABA ANNUAL REPORT

LEVEL UP?



DEAR INVESTORS, PARTNERS, AND STAKEHOLDERS,

On behalf of KABA's Board and staff, I am pleased to share the Kenosha Area Business Alliance's Annual Report for 2021.

The pages that follow share highlights from another robust year of development in Kenosha County.

Major development projects previously announced were completed or advanced considerably. Sizable new investments were initiated as well.

An unprecedented level of industrial real estate development continues along the I-94 corridor and throughout Kenosha County.

Strong job growth and resiliency is notable, as area employment now exceeds pre-pandemic levels. Incomes and wages are rising. This is fueling consumer spending and, specifically, the demand for housing.

These are largely positive indicators of Kenosha County's economic strength.

However, challenges loom and require attention:

- An incredibly tight labor market and discouraging demographic trends (an aging population with moderate growth) give rise to concerns about future labor supply;
- Housing market constraints limit the development of new homes and stifle population growth;
- Economic opportunities and benefits are not evenly distributed throughout the community and disparities in education, income, wealth and health persist;
- While our County has experienced population growth and higher levels of educational attainment and income, these gains are less impressive when compared with peer communities.

The track record in Kenosha County over the past decade is largely positive with respect to attracting new investment and job opportunities. Increasingly we need to connect the dots and work to ensure that we fully leverage these wins and maximize the benefits to the broader community.

Likewise, Kenosha County must continue to attract and retain people. The typical draws: jobs/career opportunities, quality housing, good schools, recreational opportunities, amenities, affordability, etc. . . . are available here. We need to focus on making them ubiquitous.

Increasingly, talent has choices about where they want to live and work. To ensure the County's sustained prosperity, we need to generate new economic opportunities, maximize the community benefit, and work to ensure that Kenosha County is an appealing destination for new residents.

Best wishes for a prosperous 2022.

Sincerely,



Todd Battle, President



In 2021, KABA extended **\$4.25 million** in economic development financing to **six area companies**. These funds assisted or supported projects that resulted in nearly **\$90 million of new investment** and almost **550 jobs** created/retained.

Note: These numbers do not include COVID-19 and DRM grant funding.



Twin Lakes-based Five Star Fabricating recently completed a major expansion at its HQs and manufacturing campus. This nearly \$15 million investment involved the construction of a new 100,000 SF facility and the installation of a new coatings machine.

HELPING KENOSHA COUNTY COMPANIES GET TO THE NEXT LEVEL.

Using a combination of state and local resources, KABA helps companies navigate financing options and incentive programs to lay the foundation for success.

Revolving Loan Fund Program

KABA has helped hundreds of companies to relocate or expand in Kenosha County through its portfolio of community revolving loan funds which total \$30+ million. These funds are used to provide low-cost financing to companies creating jobs by expanding or establishing a new facility in Kenosha County.

COMPANY:
**Vonco Products,
LLC**

DESCRIPTION:
**Flexible
Packaging**

PROJECT:
**Equipment
expansion**

TOTAL
INVESTMENT:

\$6 million

KABA LOAN
AMOUNT:
\$800,000

JOBS
CREATED/
RETAINED:
153

COMPANY:
**Five Star
Fabricating, Inc.**

DESCRIPTION:
**Plastic
thermoformer**

PROJECT:
**Equipment
expansion**

TOTAL
INVESTMENT:

\$700,000

KABA LOAN
AMOUNT:
\$250,000

JOBS
CREATED/
RETAINED:
10

COMPANY:
Balcan USA, Inc.

DESCRIPTION:
**Protective film
and packaging**

PROJECT:
**Establishing first
manufacturing
plants in the U.S.**

TOTAL
INVESTMENT:

\$55 million

KABA LOAN
AMOUNT:
\$1 million

JOBS
CREATED/
RETAINED:
60

COMPANY:
**Kenosha Uptown
Lofts, LLC**

DESCRIPTION:
**Development/
Construction**

PROJECT:
**Multi-use
commercial/
residential
development**

TOTAL
INVESTMENT:

\$20 million

KABA LOAN
AMOUNT:
\$1.2 million

JOBS
CREATED/
RETAINED:
N/A

COMPANY:
**S.A.M.S. Leasing
Company, LLC (DBA
Horizon Systems
Machining, Inc.)**

DESCRIPTION:
CNC Milling

PROJECT:
**Real estate
acquisition**

TOTAL
INVESTMENT:

\$1,575,000

KABA LOAN
AMOUNT:
\$700,000

JOBS
CREATED/
RETAINED:
25

Kenosha County High Impact Fund

The Kenosha County High Impact Fund administered by KABA, helps secure high quality economic development projects. "High Impact" developments are those which create at least 50 new, high paying jobs or have a capital investment of at least \$3 million.

Since its inception, the High Impact Fund has contributed to the creation of almost 2,020 new jobs and \$306 million in new private investment.

COMPANY: **Nosco, Inc.**

DESCRIPTION:
Packaging solutions

PROJECT:
Relocation to Kenosha County

TOTAL INVESTMENT: **\$8 million**

HIGH IMPACT AWARD:
\$200,000

JOBS CREATED/RETAINED: **300**

COMPANY: **Balcan USA, Inc.**

DESCRIPTION:
Protective film & packaging

PROJECT:
**Establishing first manufacturing
plants in the U.S.**

TOTAL INVESTMENT: **\$55 million**

HIGH IMPACT AWARD: **\$100,000**

JOBS CREATED/RETAINED: **60**

KENOSHA COUNTY'S

TOP 20

IN 2021

1. 8+ MILLION SF OF CONSTRUCTION

Throughout 2021 and into 2022, there has been an unprecedented level of industrial construction. During the past year, over 5 million SF of speculative industrial development was completed or started. Additionally, over 3 million SF of build to suit industrial construction was underway for specific users.



2. AMAZON

Amazon is leasing a 1,004,400 SF distribution center near its existing facility in the City of Kenosha, creating up to 400 new jobs. Amazon will occupy the entire newly-built facility to use as a regional distribution and sortation center. Facility launch is expected in early 2023.

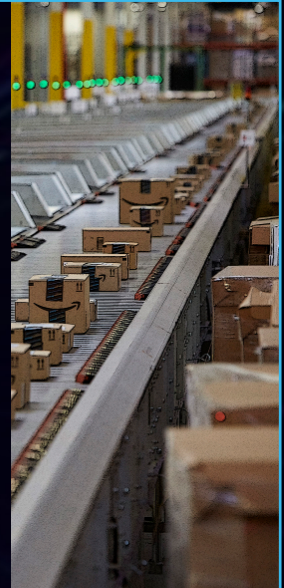

3. ASSA ABLOY / ENTREMATIC

Swedish door systems manufacturer Assa Abloy/ Entrematic leased 118,000 SF of a 315,000 SF newly-constructed facility in the Bristol Business Park, developed by The Janko Group.

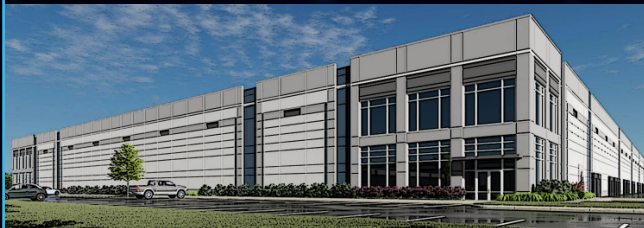

4. BALCAN USA

Montreal-based Balcan Plastics Inc. expanded operations into an existing 215,000 SF building in Pleasant Prairie's LakeView Corporate Park. The company will initially employ 60 workers, but the workforce could eventually total 120 people. Balcan Plastics produces protective film solutions and packaging for a variety of industries. Their new building in Kenosha County is the company's first production operation in the U.S.



5. COBG LOAN PROGRAM

KABA partnered with the Village of Pleasant Prairie to facilitate the close out of a sizable Community Development Block Grant program. Through this process, which involved the utilization of block grant funding and mechanisms for Village infrastructure projects, KABA was able to retain over \$5 million in revolving loan fund monies that can be used in perpetuity to support Kenosha County Economic Development projects.

7. DRM PROGRAM

KABA has administered the Disaster Recovery Microloan (DRM) Program on behalf of the Wisconsin Economic Development Corporation (WEDC). The DRM program provided assistance to local businesses that suffered measurable physical damage to their buildings/businesses due to the civil unrest that occurred in August of 2020. KABA funded \$4 million in interest free loans to 63 different businesses in the City of Kenosha to make necessary repairs and rebuild inventory.



6. DIRECT METALS

Direct Metals relocated its Waukegan, IL distribution and fabrication operations to Pleasant Prairie. The Kennesaw, GA-based distributor of industrial metal and fiberglass products acquired a 72,324 SF facility in LakeView Corporate late in 2021. Direct Metals has approximately 30 full time employees at this location.

8. HARIBO

Haribo is currently constructing Phase I of its four-phase North American production site. The German confectionery company expects to complete its initial phase in late 2022, which includes 606,870 SF of space including production, warehouse, and administrative offices. The project represents a capital investment of \$300+ million and will result in roughly 400 new, high-paying jobs. Haribo's North American business continues to grow and additional phases are anticipated in the near future. Haribo's site in Prairie Highlands Corporate Park is roughly 140 acres. When all four phases are complete, this will be one of the largest confectionery sites in the U.S. with up to 2 million SF of space and nearly 1,500 employees.



9. HEARTLAND PRODUCE

Heartland Produce has built a new \$29 million HQs and distribution facility in Kenosha with room for future expansion. The company is the first tenant of the Greenway Development at the former Dairyland Greyhound Park site.



10. INSPIRE

Inspire was a day full of connection, insights and inspiration for the nearly 550 attendees at the half-day leadership development event October 15. Four speakers engaged the audience with different takes on leadership while UW-Parkside's Willie Jude and Building Our Future's Brandon Morris served as co-emcees.

11. KENOSHA COUNTY ACHIEVES AAA

Kenosha County received a bond rating upgrade to Triple A (AAA), the highest possible, from Standard & Poor's. AAA is the strongest or highest level of creditworthiness and Kenosha County is now among only seven of the state's 72 counties that has attained a Triple A rating.



12. KIN

The City of Kenosha has approved adopted a master plan for the Kenosha Innovation Neighborhood on the city's 107-acre former Chrysler plant. The State of Wisconsin awarded nearly \$25 million in grant funds to boost development of the KIN, including an incubator facility for new businesses and funding toward the proposed new facility for LakeView Technology Academy.



13. KROGER FOODS

Kroger Food's 330,000 SF, \$112 million fulfillment network facility is scheduled to open in 2022 and employ app. 400 people. It is one of several similar facilities that Kroger plans to develop across the nation to build its capacity to fulfill online grocery orders. The project was aided by a WisDOT Transportation Economic Assistance (TEA) grant to make needed roadway improvements on a .8-mile section of Kenosha County H.

14. NEXUS PHARMACEUTICALS

Nexus Pharmaceuticals finished construction on its new, state-of-the-art 84,000 SF vertical manufacturing facility in the Village of Pleasant Prairie. The sterile injectable drug manufacturer has begun hiring for its facility in Prairie Highlands Corporate Park and plans to be producing drugs by Q2 2022.



15. R+D CUSTOM AUTOMATION

R+D Custom Automation opened its newly built 62,000 SF facility in the Salem Business Park. This designer/builder of automation systems relocated from Lake Villa, IL. The new HQs and production facility represents a \$6 million investment and will bring 60 jobs to Kenosha County.



16. SNAP-ON

On August 26—the day of its 100th birthday celebration—Snap-on CEO & Chairman Nick Pinchuk announced a 90,000 SF expansion at the company's Kenosha HQs. Construction on the nearly \$10 million project will be completed by the summer of 2022.

17. SQUARE ROOTS / GFS

Square Roots began operating an innovative, hydroponic indoor farming facility next to Gordon Food Service's distribution plant in Kenosha. The company will grow farm-fresh herbs and greens year-round and then picked fresh, distributing to grocery stores and restaurants throughout the region often the same day they're picked.



18. ULINE

ULINE, a privately held, family-owned distributor of shipping, industrial, and packaging materials, has continued to grow rapidly and make major investments here since relocating from IL in 2010. The company occupies nearly 8 million SF and employs app. 3,000 associates at locations throughout the County including its HQs Campus in Pleasant Prairie, a second campus in Kenosha, and multiple auxiliary facilities in LakeView Corporate Park. ULINE's most recent expansion included two new distribution facilities totaling over 1.7 MM SF at their Kenosha Campus.

19. UPTOWN LOFTS

Madison-based developer Gorman & Company will begin construction in 2022 on a mixed-use retail/residential complex in an area of the Uptown neighborhood heavily damaged in August 2020. The project will be a mix of affordable, accessible apartments and retail, including a local grocer. The City of Kenosha and KABA are partnering with Gorman on the project. Gorman & Company recently successfully redeveloped the historic Heritage House building into the Stella Hotel & Ballroom in Downtown Kenosha.

20. VONCO PRODUCTS

Vonco Products LLC began construction on a 36,500 SF expansion of their facility in the Salem Business Park in western Kenosha County. The flexible packaging manufacturer relocated from Lake Villa, IL to become the first tenant in the park co-developed by KABA, Kenosha County, and the Village of Salem Lakes.



LEADERSHIP

KABA is governed by a 32-member board of directors and a 11-member executive committee. Board members are nominated by a committee and elected by KABA's members. In addition to the board of directors, a number of committees are active in various aspects of the organization including finance, audit, and personnel. KABA's Board and Committee listing reflects composition as of April 27, 2022.

Board of Directors



CHAIR
Jens Emerson
Staff VP of
Finance,
Froedtert South



VICE CHAIR
Wes Saber
Executive Vice
President &
CFO, Haribo of
America, Inc.



SECRETARY
Chris Weyker
CEO,
Kenosha
Achievement
Center, Inc.

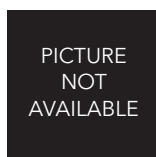

TREASURER
Anne Arbas
Senior Vice
President & CFO,
Jockey
International



**IMMEDIATE
PAST CHAIR**
Dr. John Swallow
President,
Carthage College

Committees

AUDIT

Jens Emerson**
Kathleen Goessl
Cherie Julius
Ken Konjura
Patricia Merrill
David Nankin
Karl Ostby
Wes Saber*

*denotes incoming Chair
**member, Chair until
completion of 2021 audit

Ayesha Ahmed
General Counsel,
Nexus Pharmaceuticals

Dr. Bryan Albrecht
President, Gateway
Technical College

Sue Block
VP - Finance, Uline

Joel Burow
Manager, Customer
Solutions,
WEC Energy Group

Varun Chaudhary
General Manager,
Amazon

Tamarra Coleman
Executive Director,
Shalom Center

Joshua Ferguson
Owner,
PlaySpace Kenosha

Dr. Deborah Ford
Chancellor,
University of
Wisconsin-Parkside

Jamie Hogan
President, Specialized
Accounting Services

Donna Jamieson
President,
Aurora Medical Center
- Kenosha

Anthony Jefferson, Sr.
Owner, Five-Star
Moving Crew

A.J. Kegg
President, Horizon
Systems Machining

Tom King
VP of Supply Chain,
InSinkErator

Jim Kinney
Chairman
State Bank of the Lakes

Josh Kosmala
Senior Director of
Operations,
Good Foods Group

Christie Lawson
General Manager,
Industrial Business, MTI
- A Steel Partners Co.

Tom Moore
Senior VP, Senior
Commercial Banking
Manager, Johnson
Financial Group

Chad Navis
Vice President, Zilber
Property Group

Bethany Ormseth
Interim Superintendent
of Schools, Kenosha
Unified School District

Aldo Pagliari
Senior VP - Finance
& CFO, Snap-on
Incorporated

Mike Pitts, Jr.
Owner, Pitts Brothers
& Associates

Matt Prince
CEO, Riley
Construction Company

Corey Schultz
VP of Sales &
Marketing,
Five Star Fabricating

Charles Skendziel
Owner, Equity Creative

Maureen Sorensen
VP - Operations, RPM
International, Inc. -
Specialty Coatings
Group

Mike Thompson
President & CEO,
Fair Oaks Foods

Wayne Wehking
Executive VP Sales &
Marketing,
Kenosha Beef
International

Sage Greising
Kurt Penn
Dr. Sue Savaglio-Jarvis

EXECUTIVE

Anne Arbas
Sue Block
Jens Emerson (Chair)
Jamie Hogan
Donna Jamieson
Chad Navis
Aldo Pagliari
Wes Saber
Charles Skendziel
Dr. John Swallow
Chris Weyker

FINANCE

Mike Deney
Jon Purcell
Wesley Ricchio
Melissa Thompson
Christian Venegas
Sara Verbsky (Chair)
Kyle Vitkus
Andy Vogel
Chris Ziarko

NOMINATING

Sue Block
Jens Emerson (Chair)
Wes Saber
Dr. John Swallow
Chris Weyker

PERSONNEL

Jens Emerson (Chair)
Wes Saber
Dr. John Swallow

Staff

Todd Battle, President
Lisa Feltson, Office Manager
Jeanne Geiger, Administrative Assistant

Heather Wessling Grosz, Vice President
Brooke Infusino, Director of
Talent Development

Becky Noble, Director of Marketing
Brock Portilia, Director of Finance &
Administration



"The speakers were top notch - truly inspiring leaders. I looked around at my team at the end of the event, and a few were in tears. It was such a beneficial day for my team and it was great to be back in person again."

– Shannon Hill, Balcan Plastics

KABA held several in-person events in 2021 including the Inspire leadership conference, several workshops, and the KABA Holiday Social.

FINANCIAL INFORMATION

Kenosha Area Business Alliance, Inc. and its Subsidiaries

Unaudited Consolidated Statement of Financial Position Compiled for the Years Ending:

| | 2021 | 2020 |
|--|----------------------|----------------------|
| Assets | | |
| Cash & Short Term Investments | \$ 10,426,338 | \$ 9,420,382 |
| Notes/Advances Receivable Less Reserves | 16,291,679 | 14,695,863 |
| Other Assets | 2,946,552 | 3,579,152 |
| Total Assets | \$ 29,664,569 | \$ 27,695,397 |
| Fixed Assets | | |
| Property & Equipment Net of Accumulated Depreciation | 16,251,441 | 12,321,935 |
| Total Assets & Fixed Assets | \$ 45,916,010 | \$ 40,017,332 |
| Liabilities | | |
| Accounts Payable & Other Short Term Liabilities | 2,460,271 | 3,685,720 |
| Notes Payable | 11,521,761 | 6,949,736 |
| Total Liabilities | \$ 13,982,032 | \$ 10,635,456 |
| Net Assets | | |
| Unrestricted | 16,788,169 | 10,961,696 |
| Temporarily Restricted | 15,145,809 | 18,420,180 |
| Total Net Assets | \$ 31,933,978 | \$ 29,381,876 |
| Total Liabilities and Net Assets | \$ 45,916,010 | \$ 40,017,332 |

Unaudited Consolidated Statement of Activities - All Funds, Compiled for the Years Ending:

| | 2021 Operating | 2021 Loan Funds/Bldng | 2020 Operating | 2020 Loan Funds/Bldng |
|--|--------------------|--------------------------|---------------------|--------------------------|
| Revenues | | | | |
| Contract Services | \$ 210,000 | \$ — | \$ 210,000 | \$ — |
| Membership Dues | 328,363 | — | 371,250 | — |
| Loan Service Fees | 69,315 | — | 82,471 | — |
| Training/CEO Roundtable Fees | 46,380 | — | 57,696 | — |
| Interest (Bank, Investments & Notes) | 87 | 542,206 | 2,456 | 467,628 |
| Revolving Loan Fund Administration | 720,000 | — | 491,560 | — |
| Rent | — | 698,126 | — | 547,654 |
| Other (Grant Revenue) | 65,508 | 4,674,295 | 54,460 | 4,066,930 |
| Total Revenue | \$ 1,439,653 | \$ 5,914,627 | \$ 1,269,893 | \$ 5,082,212 |
| Expenses | | | | |
| Personnel Costs | 1,099,680 | — | 1,066,277 | — |
| Revolving Loan Fund Administration | — | 720,000 | — | 491,560 |
| Travel / General Admin / Training / CEO Roundtable | 99,699 | — | 74,089 | — |
| Office Equipment | 4,456 | — | 2,829 | — |
| Mailing/Printing / Office Supplies | 6,817 | 95 | 5,854 | 341 |
| Accounting / Auditing / Legal | 29,508 | 108 | 29,789 | 26 |
| Insurance (Business & General Liability) | 17,097 | 5,000 | 14,405 | 5,000 |
| Telecommunications / Computer Services | 37,906 | 1,309 | 38,216 | 1,076 |
| Rent / Space Maintenance / Utilities | 100,721 | 32,149 | 101,020 | 24,890 |
| Membership & Business Development | 40,231 | — | 35,015 | — |
| Depreciation & Property Taxes & Interest | 24,068 | 599,394 | 17,767 | 731,449 |
| Other (Grant Expense) | — | 2,090,750 | — | 3,161,310 |
| Reserve Adjustment | — | (124,000) | — | (33,000) |
| Total Expenses | \$ 1,460,183 | \$ 3,324,805 | \$ 1,385,261 | \$ 4,382,652 |
| Change In Net Assets | \$ (20,530) | \$ 2,589,822 | \$ (115,368) | \$ 699,560 |

2021 KABA INVESTORS

BANKING

Blackhawk Community Credit Union
BMO Harris Bank
Community State Bank

Educators Credit Union
First American Bank
First Business Bank
Heartland Bank and Trust Company

Johnson Financial Group
PNC Bank
Southern Lakes Credit Union

State Bank of the Lakes
Tri City National Bank
TruStone Financial Federal Credit Union

US Bank
Wintrust Commercial Banking at Town Bank

BUSINESS SERVICES

Alarm Detection System Inc.
Brookstone Printing
Catalyst Exhibits, Inc.
Chef David's Catered Events
Converting Solutions, Inc.
Econoprint

First Onsite
Hallum Enterprises, Inc.
Imperial Service Systems, Inc.
Kenosha Private Police
Leitch Printing Corporation

Len laquinta's Excellence in Communications, Inc.
Living As A Leader
Martin Group
Minuteman Press Kenosha
OFS

Perrine Property Maintenance, LLC
Professional Services Group, Inc.
Signarama

The Colergét Conference Center
The Payroll People
Valor Manufacturing Training
Winter Services LLC

CONSTRUCTION & RELATED INDUSTRIES

Bane-Nelson, Inc.
Berghammer Construction Corporation
Bukacek Construction Group, Inc.
C.G. Schmidt, Inc.
Camosy Construction
Cicchini Asphalt, LLC

CPO Commercial Flooring a division of Carpets Plus Outlet
Dickow-Cyzak Tile Company
DORAL Corporation
Electrical Contractors of Wisconsin, Inc.
Gilbane Building Company

Greenfire
J.H. Findorff & Son Inc.
JDR Painting LLC
Joseph J. Henderson & Son, Inc.
Keller, Inc.
Kenosha Plumbing
Kitchen Cubes
Lee Mechanical Inc.

Liftpro, LLC
Martin Petersen Co, Inc.
Miron Construction Co., Inc.
MSI General Corporation
NEXT Electric, LLC.
Pepper Construction
Point Ready Mix, LLC
Postorino Construction Finishes

Rasch Construction & Engineering, Inc.
Riley Construction Company, Inc.
Stuckey Construction Company, Inc.
Thompson Project Management, LLC

ENGINEERING & ARCHITECTURAL SERVICES

Clark Dietz, Inc.
DLH Consulting Services, LLC
Garland Alliance, Inc.

Graef - USA
Harwood Engineering Consultants

JSD Professional Services, Inc.
Kueny Architects, LLC

Partners in Design Architects, Inc.
Pinnacle Engineering Group

raSmith
Ruekert Mielke
The Sigma Group, Inc.

GOVERNMENT & EDUCATION

Carthage College
City of Kenosha
Gateway Technical College
Herzing University
Kenosha County

Kenosha High School of Technology Enhanced Curriculum
Kenosha Unified School District

St. Joseph Catholic Academy
The Prairie School
Town of Brighton
Town of Paris
Town of Wheatland

University of Wisconsin-Parkside
Village of Bristol
Village of Paddock Lake
Village of Pleasant Prairie

Village of Salem Lakes
Village of Somers
Village of Twin Lakes
Wilmot Union High School District

HEALTH CARE & RELATED INDUSTRIES

Abbott
Advocate Aurora Health
Daniel R. Santarelli DDS
Doctors of Physical Therapy

Froedtert South
Frontida, Inc.
Fulmer Dentistry
Guided Wellness Counseling, SC

Hospice Alliance
Kenosha Community Health Center, Inc.
Kenosha Radiology Center

Kenosha Visiting Nurse Association & Affiliates
LivingWell Home Medical Supplies, Inc.

Nexus Pharmaceuticals, Inc.
OccuCare
Sports Physical Therapists
United Occupational Medicine

INDIVIDUAL

Susan Crane
Ronald Frederick

Nancy Haggerty

Representative Samantha Kerkman

County Executive Jim Kreuser

Michael Montemurro
Justin Silva

INSURANCE, LEGAL & FINANCIAL SERVICES

Alia, DuMez & McTernan, S.C.
Ameriprise Financial Services, Inc.
Andrea & Orendorff, LLP
CliftonLarsonAllen LLP
Davison Law Office, Ltd.
Deiningner & Co., Inc.
DeWitt LLP

Ehlers and Associates, Inc.
Fitzpatrick Group of Wells Fargo Advisors
Gateway Mortgage Corporation
Godfrey & Kahn S.C.
Godin Geraghty Puntillo Camilli, SC
Guttormsen & Hartley, LLP

Jacsten
Lindner & Marsack, S.C.
Lueder Financial Group - Northwestern Mutual
Marsh & McLennan Agency LLC
O'Neil, Cannon, Hollman, DeJong & Laing S.C.

Prophet Wealth Management
Sam Ruffolo Agency
Scott Olson, CPA, LLC
Seymour & Associates, S.C.
Specialized Accounting Services LLC
The Horton Group

Thomey Financial Services & Michael J Thomey, CPA
Trotter Insurance Group
Trustant Insurance
Valeri Agency, A Vitalize Company
Vrakas CPAs + Advisors
Wipfli LLP

IT SERVICES

CCB Technology
CMIT Solutions of SE Wisconsin

Computer Technologies, Inc.

DeKind Computer Consultants

Leeward Business Advisors
NSR Business Solutions

Offsite, LLC
Platinum Systems, Inc.

2021 KABA INVESTORS

MANUFACTURING

| | | | | |
|---|---|---|--|---|
| 4Front HPD NA Abatron, Inc. Advent Tool & Manufacturing, Inc. Allied Plastics, Inc. Ardent Mills LLC Ariens Company ASYST Technologies LLC Badgerland Products, Inc. Balcan USA Inc Beckart Environmental, Inc. Bio Fab Technologies, Inc. Bone Dry Products Bradshaw Medical Inc. | Colbert Packaging Corporation Contact Rubber Corporation Cordeck EMCO Chemical Distributors, Inc. Fair Oaks Foods Finishing & Plating Service, Inc. Five Star Fabricating, Inc. FNA Group Inc. Form Machining LLC GEM Manufacturing Inc. Good Foods Group, LLC Haribo | Horizon Systems Machining, Inc. Industrial Toolz/Handi Ramp InSinkErator IRIS USA, Inc. Jockey International, Inc. Kenall Kenosha Beef International, Ltd. Kenosha Lumber & Manufacturing Co., Inc. Kirsan Engineering, Inc. L & M Corrugated Container Corp. LMI Packaging Solutions, Inc. | Medtorque, Inc. Mikrotech, LLC MTI – A Steel Partners Company Northlake Engineering, Inc. Nosco Ocean Spray Cranberries, Inc. Ocenco, Inc. Powerbrace Corporation Puratos Corporation Quest Products, LLC R+D Custom Automation RCK Foods Reflective Concepts, Inc. Rehrig Pacific Company | RPM International Inc. - Specialty Coatings Group Rust-Oleum Corporation S.C. Johnson & Son Silgan Containers Snap-on Incorporated Stabio North America, LLC The Metal Shop Thyssenkrupp Materials - Ken-Mac Metals Division Toolamation, Inc. UCC Environmental ViskoTeepak Vonco Products, LLC |
|---|---|---|--|---|

MEDIA/MARKETING/DESIGN

| | | | | |
|---|-----------------------------|----------------|-----------------|-----------------|
| Dooley & Associates, LLC Equity Creative | Kenosha News Kenosha.com | Pellizzi & Co. | The Gratz, Inc. | Upload Partners |
|---|-----------------------------|----------------|-----------------|-----------------|

NON-PROFIT

| | | | | |
|---|---|---|---|--|
| Ascension All Saints Hospital Foundation Boys & Girls Club of Kenosha Goodwill Industries of Southeastern Wisconsin, Inc. Journey Church | Kenosha Achievement Center, Inc. Kenosha Area Chamber of Commerce, Inc. Kenosha Community Foundation | Kenosha Country Club Kenosha County Food Bank Kenosha Human Development Services, Inc. Kenosha YMCA | Lake County Partners MRA Pleasant Prairie Convention & Visitors Bureau Shalom Center of the Interfaith Network | Southshore Realtors Association, Inc. The Sharing Center United Way of Kenosha County Visit Kenosha |
|---|---|---|---|--|

REAL ESTATE

| | | | | |
|--|---|---|---|---|
| Bear Real Estate Group Berkshire Hathaway Home Services Epic Real Estate Clovis Point, LLC Cove Realty Darwin Realty & Development Corporation | Douglas Kent Development, Inc. First Industrial Realty Trust, Inc. Franke Development Advisors LLC Garretto Real Estate LLC | Gorman & Company, Inc. Janko Group Lee & Associates of Illinois LLC Legacy Property Management Services, LLC | Newmark Knight Frank Petretti Builders & Developers Pitts Brothers & Associates LLC Prime Realty Group of Wisconsin, LLC | SVN Hintze Commercial Real Estate Tri-State Realty, Ltd. Venture One Real Estate, LLC Wangard Partners, Inc. Zilber Property Group |
|--|---|---|---|---|

RETAIL ESTABLISHMENTS

| | | | | |
|--|--|--|--|---|
| Apis Hotel and Restaurant Candlewood Suites Carpets Plus Outlet, Inc. Cast, LLC DBA Sazzy B | Chiappetta Shoes, Inc. Crown Trophy & HTE Promotional Kenosha Kingfish Baseball Club | LaMacchia Travel NorthPoint Development Office Furniture Warehouse Paielli's Bakery, Inc. | PlaySpace Kenosha Rustic Road Brewing Co. Springhill Suites by Marriott Kenosha | Tenuta's Delicatessen & Liquors, Inc. The Club at Strawberry Creek Total Furniture Woofman's Lodge Pet Resort |
|--|--|--|--|---|

STAFFING SERVICES

| | | | | |
|------------------------------------|-------------------------------------|---|---------------------------|---|
| Atlas Employment Services, Inc. | Express Employment Professionals | Halpin Staffing Services Matthews Professional Employment, Inc. | Parallel Employment Group | TempsNow Employment & Placement Services LLC |
|------------------------------------|-------------------------------------|---|---------------------------|---|

TELECOMMUNICATIONS & UTILITIES

| | | | |
|----------------|--------------|------------------|--------------------------|
| Alliant Energy | ClearCom Inc | WEC Energy Group | Wisconsin Fuel & Heating |
|----------------|--------------|------------------|--------------------------|

TRANSPORTATION, DISTRIBUTION & WAREHOUSING

| | | | | |
|---|---|--|--|---|
| Affordable Auto Sales Amazon ATC Transportation LLC CJW Inc. Doheny's | Five-Star Moving Crew Fresenius Medical Care/ TruBlu Logistics Geneva Supply GFI Midwest LLC Heartland Produce Co. | Kem Krest Kutzler Express, Inc. Meijer Midwest Refrigerated Services | Otto Nelson Moving and Storage Palmen Auto Stores Pepsi Beverages Company SMT Packaging Trifinity | Uline, Inc. VP Xpress, LLC Yamaha Motor Corporation, USA |
|---|---|--|--|---|

OUR VISION

Kenosha County is the premier destination for new investment and talent in the Chicago Milwaukee corridor.

The Kenosha Area Business Alliance (KABA) is Kenosha County's economic development organization and business association.

A public-private partnership, KABA is focused on making the Kenosha Area a better place to do business, live, and work, through: (1) economic development initiatives that stimulate private sector investment and job creation; (2) providing programs, products, and services that improve the competitiveness of Kenosha Area employers and their employees; and (3) supporting educational initiatives with a goal of enhancing student achievement and overall school performance.



5500 Sixth Avenue, Suite 200, Kenosha, WI 53140
262.605.1100 | info@kaba.org

www.kaba.org

