

AVAILABLE
44,398 SF

8201
104TH
STREET

PLEASANT PRAIRIE, WI

AVAILABLE: 44,398 SF (Expandable)
OFFICE: 22,267 SF
(11,334 SF 1st Fl / 11,133 SF 2nd Fl)
YEAR BUILT: 1996
CLEAR HEIGHT: 24'
LOADING: 2 Docks
2 Drive-In Doors
POWER: 1200 Amps @ 480 / 277 Volts
PARKING: 107 Cars (expandable)
SITE SIZE: 4.66 Acres



FOR MORE INFORMATION PLEASE CONTACT:

Keith D. Puritz

Senior Vice President

847.572.1410

keith.puritz@cbre.com

Brett A. Kroner

Senior Vice President

847.572.1411

brett.kroner@cbre.com

Ryan S. Bain

Vice President

847.572.1412

ryan.bain@cbre.com

Zachary C. Graham

Senior Associate

847.572.1415

zach.graham@cbre.com

CBRE

- Located minutes off I-94 just North of Illinois / Wisconsin border in prestigious LakeView Corporate Park.
- 2-story office with excellent window line, elevator and functional layout.
- High image facility with great identity on main thorough fare through business park.
- Large land site. Building and parking expandable.
- **Ideal for call center, life science, pharma, technology, engineering, and other heavy office.**

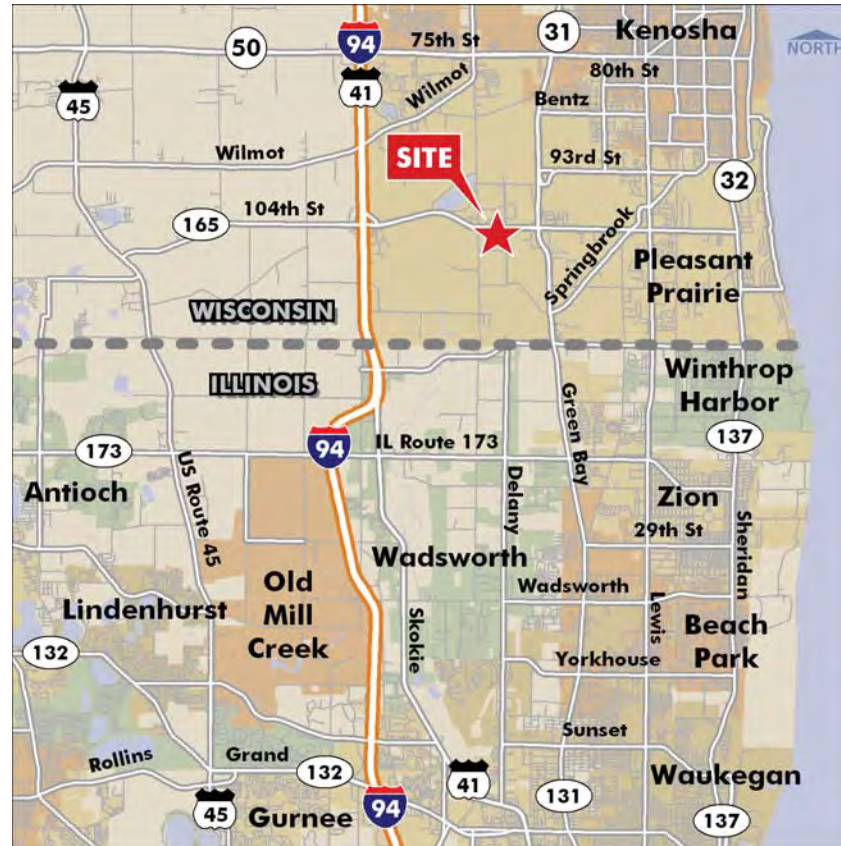

**FOR MORE INFORMATION
PLEASE CONTACT:**

Keith D. Puritz
Senior Vice President
847.572.1410
keith.puritz@cbre.com

Brett A. Kroner
Senior Vice President
847.572.1411
brett.kroner@cbre.com

Ryan S. Bain
Vice President
847.572.1412
ryan.bain@cbre.com

Zachary C. Graham
Senior Associate
847.572.1415
zach.graham@cbre.com

CBRE
3000 Lakeside Drive, Suite 105 S
Bannockburn, IL 60015
www.cbre.com

Lease Rate: \$5.95 p.s.f. net

Sale Price: \$2,445,000 (\$55.07 p.s.f.)

2010 R. E. Taxes: \$0.82 p.s.f. (\$36,530)

**FOR MORE INFORMATION
PLEASE CONTACT:**

Keith D. Puritz

Senior Vice President
847.572.1410
keith.puritz@cbre.com

Brett A. Kroner

Senior Vice President
847.572.1411
brett.kroner@cbre.com

Ryan S. Bain

Vice President
847.572.1412
ryan.bain@cbre.com

Zachary C. Graham

Senior Associate
847.572.1415
zach.graham@cbre.com

CBRE

3000 Lakeside Drive, Suite 105 S
Bannockburn, IL 60015

www.cbre.com

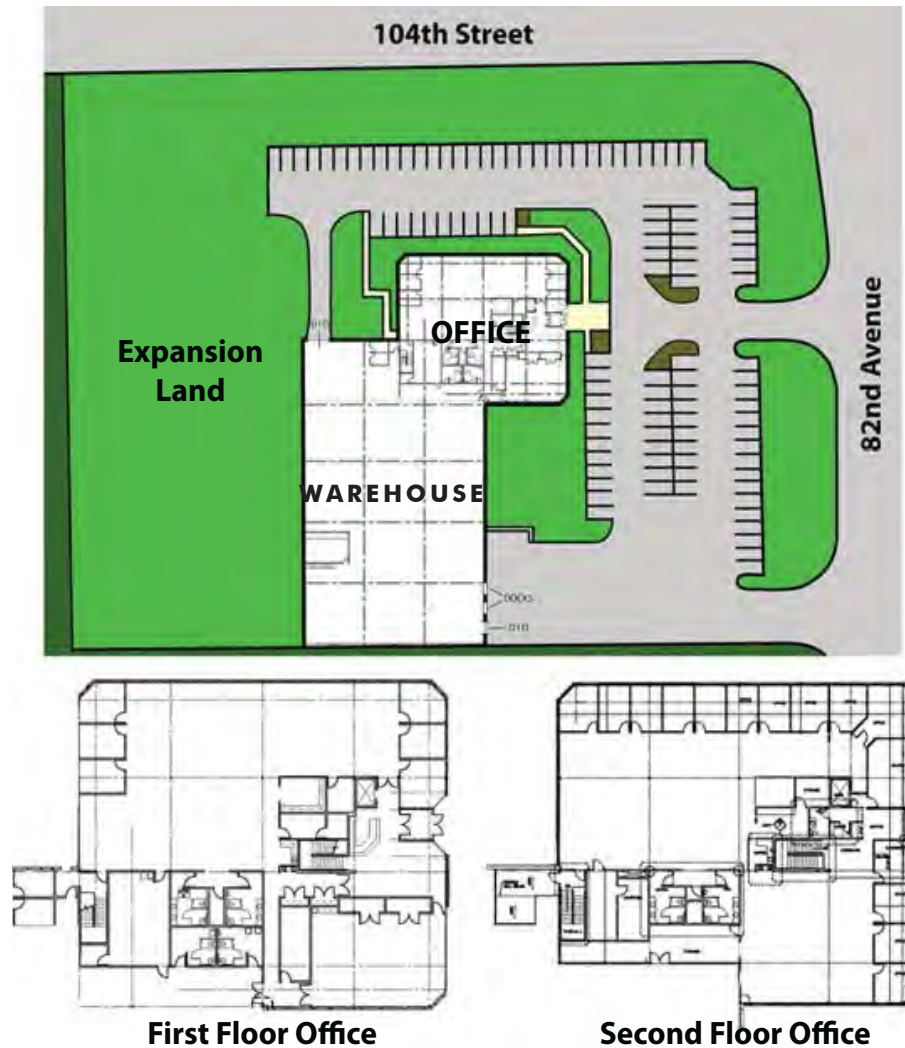



**FOR MORE INFORMATION
PLEASE CONTACT:**

Keith D. Puritz

Senior Vice President
847.572.1410
keith.puritz@cbre.com

Brett A. Kroner

Senior Vice President
847.572.1411
brett.kroner@cbre.com

Ryan S. Bain

Vice President
847.572.1412
ryan.bain@cbre.com

Zachary C. Graham

Senior Associate
847.572.1415
zach.graham@cbre.com

CBRE

3000 Lakeside Drive, Suite 105 S
Bannockburn, IL 60015
www.cbre.com



**8201
104TH
STREET**

PLEASANT PRAIRIE, WI

**44,398 SF
AVAILABLE**



Keith D. Puritz

Senior Vice President

847.572.1410

keith.puritz@cbre.com

Brett A. Kroner

Senior Vice President

847.572.1411

brett.kroner@cbre.com

Ryan S. Bain

Vice President

847.572.1412

ryan.bain@cbre.com

Zachary C. Graham

Senior Associate

847.572.1415

zach.graham@cbre.com

CBRE